

•SECOND FLOOR PLAN.

•FIRST FLOOR PLAN.

- SYMBOLS:**
- WALL RECEPTACLE (6" ABOVE FLOOR)
  - WALL BELL OUTLET (9" )
  - ⊖ ELEC. CLOCK OUTLET (9" )
  - ⊙ CLOCK LIGHT (8" )
  - ⊗ GAS WALL OUTLET (4" )
  - ⊕ IGNITER OUTLET (4" )
  - ⊗ WALL SWITCH (4" )
  - ⊕ WALL SWITCH & PILOT (4" )
  - ⊕ JUNCTION BOX IN CEILING (660 WATTS)
  - ⊕ CEILING LIGHTING FIXTURE
  - ⊕ ELEC. SOLDERING IRON RECEPTACLE OUTLET (4" ) ABOVE FLOOR - 200 WATTS)
  - ⊕ CEILING FAN OUTLET
  - ⊕ CEILING GAS OUTLET
  - ⊕ BASE RECEPTACLE
  - ⊕ INDICATES SEMI-INDIRECT FIXTURE
  - TR " TROJAN FIXTURE
- NOTES:-**
1. ALL FLOOR TYPE RADIATORS ARE 32" HIGH.
  2. ROOF RAFTERS SHALL BE 2" X 8" ON 16" CENTERS.
  3. A NAIL SHALL BE LEFT WITH HEAD EXPOSED AT EACH END OF EVERY CEILING JOIST OF FIRST FLOOR IN THE TERMINAL & BATTERY ROOMS.
  4. THE FLOOR IN "MENS TOILET" & "BATTERY ROOM" SHALL BE 15" REINFORCED CONCRETE SLAB - REINFORCEMENT TO BE ½" RODS 7" O.C.
  5. 9" - 10" FROM FIRST FLOOR TO GIRDER SOFFIT.

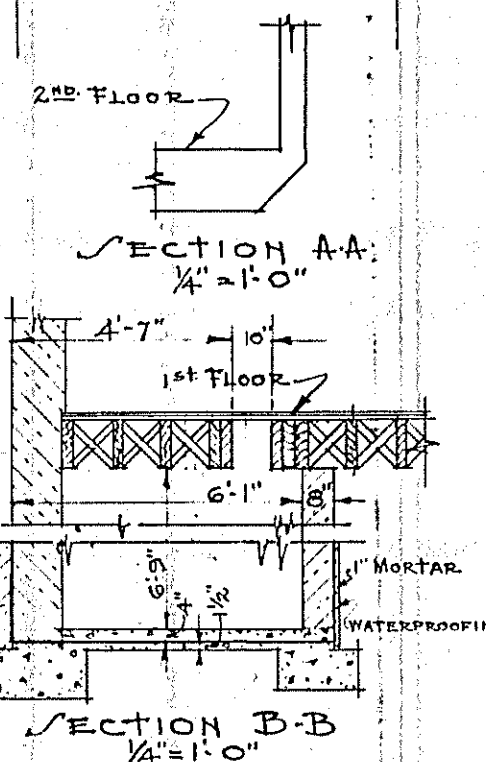

•VIRGINIA BEACH •VA. TELEPHONE BUILDING.

•FLOOR PLANS.

SCALE 1/4" = 1'-0"

ORIGINAL  
BLDG.

**MODIFICATIONS:**

1. FEB 17, 1927.  
20" I-78 # GIRDER CHANGED TO 20" I-81.4 # BY R. L. O. C.E.R.
2. MARCH 16, 1927.  
CLOCK OUTLET ADDED IN REST ROOM.  
H-5.
3. MARCH 16, 1927.  
HOT & COLD PIPES AND 2" DRAIN PIPE IN REST ROOM ADDED.  
H-5.

DATA BY: EGL.  
DRAWN BY: HJS.  
CHECKED BY: EGL.  
O. K. [Signature]  
PRINT ISSUED

SKETCH NO. A-531.